



Engineering Solutions

300 Stainless Steel Insert

Perfect for superior corrosion resistance!

Features and Benefits

- Hexagonal hole for increased spinout
- Half-hex shank and low-profile head design
- Popular metric hole sizes
- Installed with spin/pull tooling

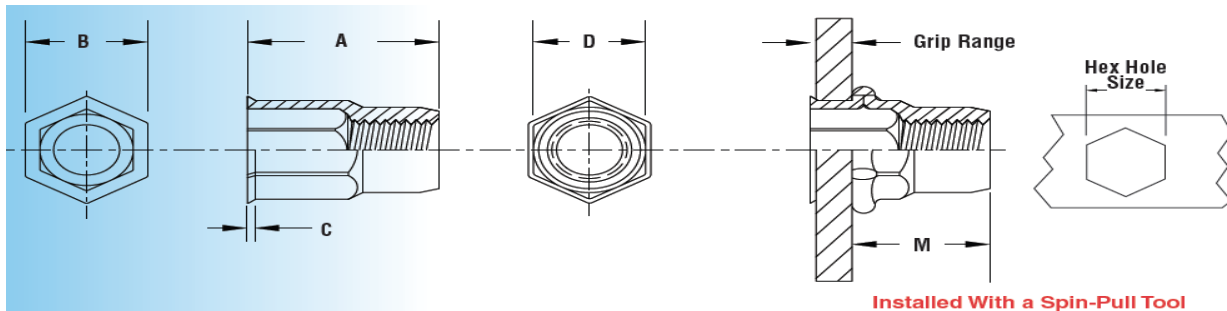

Thread size (Inches)	Grip Range (1)	A ±.010	B ±.012	C ±.004	D Max.	M Ref.	Hex Hole Size In Sheet ±.004-.000
#8-32	.020-.080	0.430	0.260	.020	0.235	.270	.236
#10-32	.020-.120	0.470	0.300	.020	0.275	.260	.276
1/4-20	.020-.120	0.570	0.380	.025	0.353	.335	.354
1/4-20	.120-.220	0.650	0.380	.025	0.353	.305	.354
5/16-18	.020-.120	0.630	0.470	.028	0.432	.355	.433
Thread size (mm)	Grip Range (1)	A ±0.25	B ±0.31	C ±0.1	D Max.	M Ref.	Hex Hole Size In Sheet ±0.1
M4	0.5-2	10.92	6.6	0.51	5.98	6.85	6
M5	0.5-3	11.94	7.62	0.51	6.98	6.6	7
M6	0.5-3	14.48	9.65	0.64	8.98	8.5	9
M6	3-5.5	16.51	9.65	0.64	8.98	7.75	9
M8	0.5-3	16	11.94	0.71	10.98	9	11

Additional thread sizes and grip ranges available.

Material & Finish Specifications

Fastener Material: 300 Series Stainless Steel **Finish:** Passivated
Threads: Unified, 2B per ASME B1.1 Metric, 6H per ASME

Performance Data available upon request.

Click here to EFC's offering of [360 Stepless Ear Clamps!](#)

Atlanta | St. Louis | Chicago | Toronto
 800.888.3326 www.efc-intl.com