



Solutions

Mid-Panel Nut with Low Insertion Force™
Perfect for Hydro-Formed Tubing Applications

EFC International is excited to introduce a new mid-panel fastener that dramatically reduces installation efforts (10 lbs max. insertion force) without sacrificing strength or pull-out forces. Additionally, during bolt installation, the lower leg member of the fastener is designed to flex, providing a clamping load to the bottom of the panel and ensuring a rattle free assembly.

For additional information, please contact EFC International at 800-888-3326.

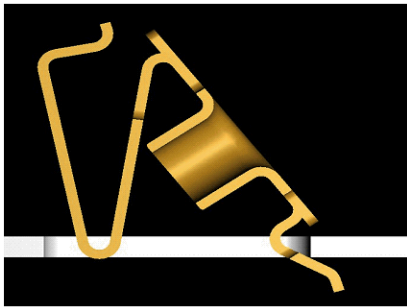

Simple to install

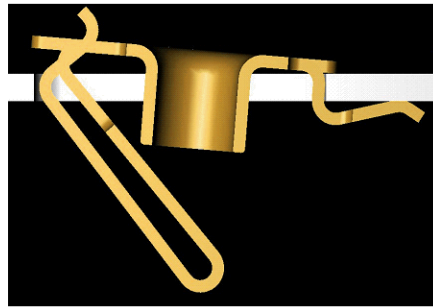

Requires 10lbs or less to install

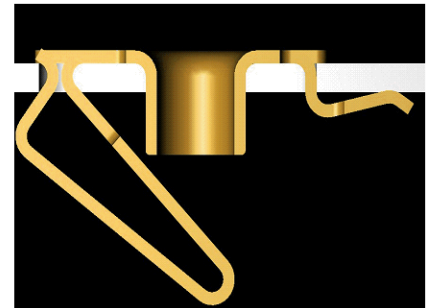

Snaps in place securely to prevent rattling.

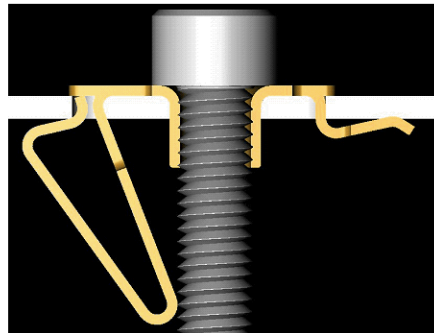

During installation of the bolt, the adjacent snap in feature is able to deflect and provide additional panel clamping.

Hydro-Form Tube Nut is a proprietary product of ITW Corporation

For more information, contact EFC International:

St. Louis (Corporate)	800-888-3326	(fax: 314-434-2902)
Chicago	800-727-8466	(fax: 630-539-7070)
Atlanta	800-541-9019	(fax: 770-663-8484)

Explore other EFC Engineering Solutions on-line at: www.efc-intl.com