

Solutions

Parallel Wire, Hose & Cable Routing Clip
Versatile, Quick-Connecting Routing Device

FASTENING WITH T-CLIPS IS A SNAP!

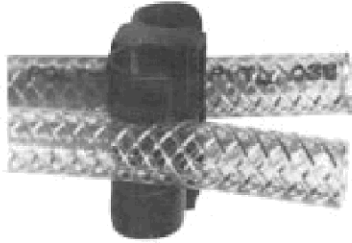

1. Place open sides of T-Clip between tubes.

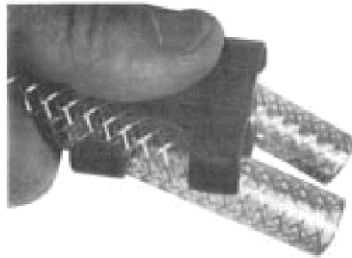

2. Snap T-Clip onto tubes with a quick, quarter turn.

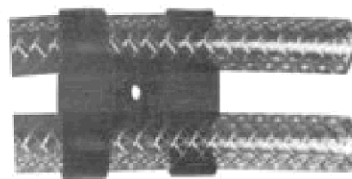

3. T-Clip is ready for mounting with tubes held in a uniform spacing.

Commercial applications, such as the installations of pneumatic and hydraulic hoses, electrical conduits and wires, telephone and fibre optics, liquid and gas tubings and pipes, and automotive, truck and boat hoses can benefit from the ease of installation, safety, and the final appearance of the job.

ENGINEERING SPECIFICATIONS

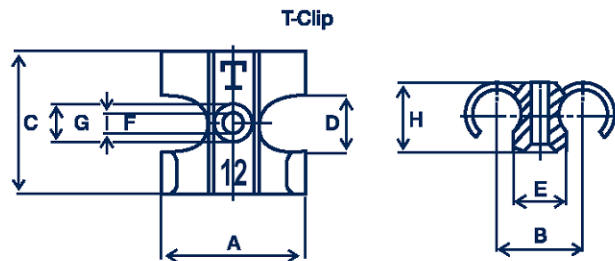

DIMENSIONS "T" - CLIPS

T-Clip Model #	Spacer Model #	Holding Range	Inches								
			A	B	C*	D	E*	F*	G	H	
T4	—	5/32-1/4	.60	.40	.72	.24	.28	.12	.24	.36	
T6	—	1/4-5/16	.80	.48	.80	.32	.32	.12	.24	.36	
T8	D8	5/16-3/8	1.00	.60	.96	.40	.40	.16	.32	.48	
T10	D10	3/8-1/2	1.24	.72	1.12	.48	.44	.16	.32	.60	
T12	D12	1/2-5/8	1.36	.84	1.40	.56	.48	.16	.36	.68	
T15	D15	5/8-3/4	1.72	1.00	1.68	.68	.56	.20	.40	.80	
T18	D18	3/4-7/8	2.04	1.24	1.96	.80	.64	.20	.48	.92	
T22	D22	7/8-1	2.60	1.56	2.52	1.00	.84	.28	.52	1.16	

*C-E & F are also spacer Length, width and depth

Spacers are available to fit T-Clips from T8 to T22 to allow for additional spacing between the mounting face and the items to be secured. As many spacers as necessary to provide required clearance can be used as the design allow stacking.

For more information, contact EFC International:

St. Louis (Corporate) **800-888-3326** (fax: 314-434-2902)
Chicago 800-727-8466 (fax: 630-539-7070)
Atlanta 800-541-9019 (fax: 770-663-8484)

Explore other EFC Engineering Solutions on-line at: www.efc-intl.com