



CHALLENGE

Customer was looking for a way to attach the LH/RH EPDM wedge to the inner panel of a rear door.

SOLUTION

EFC New Business Development and Sales redesigned the wedge and suggested putting 2 recessed holes in the wedge and attaching with 2 shoulder screws.

RESULT

The new design eliminated 2 new suppliers and eliminated in house assembly. With an annual cost savings of \$103k.

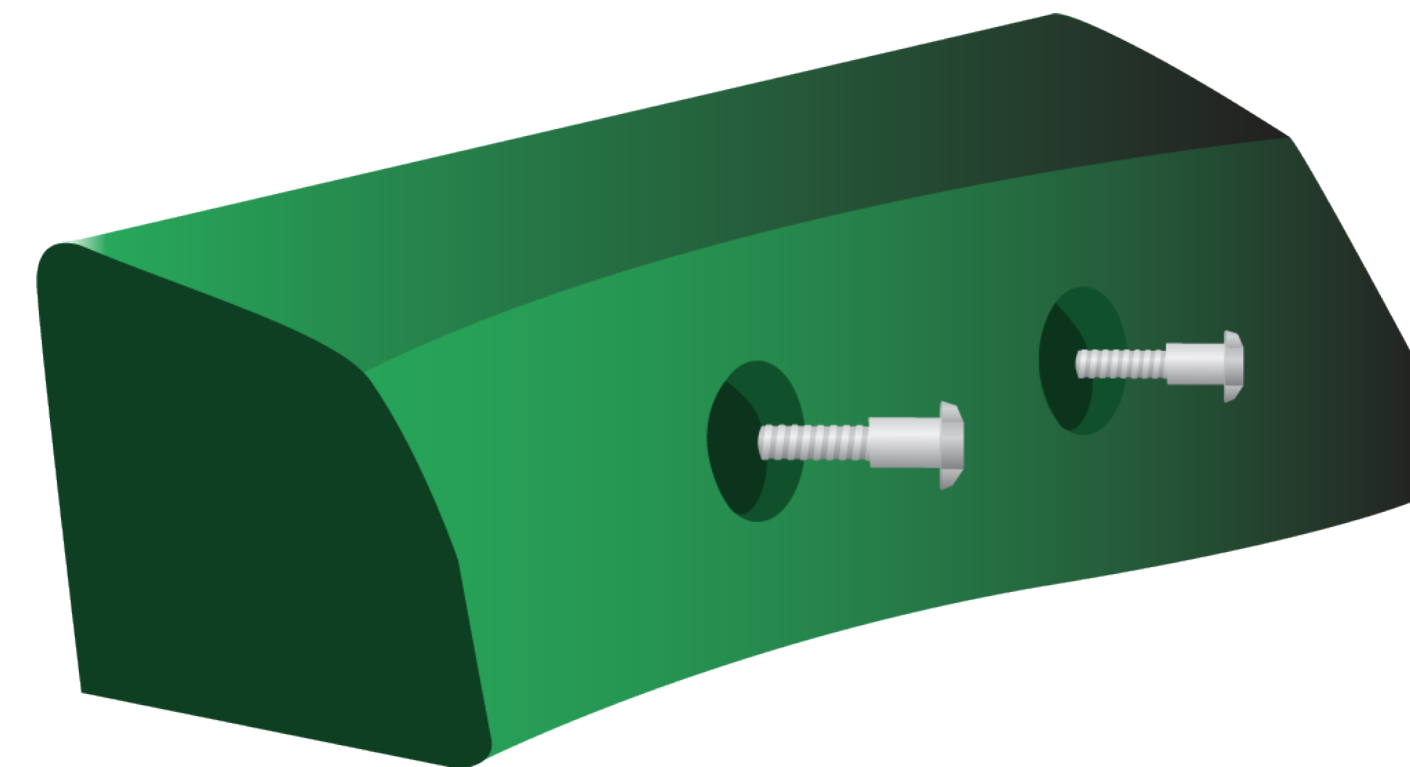

LH/RH EPDM Wedge